

Green Infrastructure PILOT PROJECT

GREEN STREETS OPTIONS for CSO NO.060

PARKDALE AVENUE: BUFFALO, NY



Street Name: Parkdale Avenue
Treatment Type: Rain Garden Inlets

Rain garden cut outs are designed to allow stormwater to flow into the garden. This rain garden is unique, it allows the rain water to percolate downward and recharge the local water table. This serves an important function, the local waterways depend on stormwater to recharge the system. This design will also reduce the amount of stormwater that enters the existing combined sewer system. This reduction will improve the quality of life in this neighborhood as it will greatly reduce the sewer overflows (pollution).



Above:
(Green Infrastructure) This design was installed in Portland, Oregon. Shown on a dry weather day. The stormwater helps to irrigate the garden as well as reducing the amount of stormwater entering the sewer system.

Left:
(Green Infrastructure) This new streetscape design, shown in a wet weather condition is installed in Seattle, Washington.

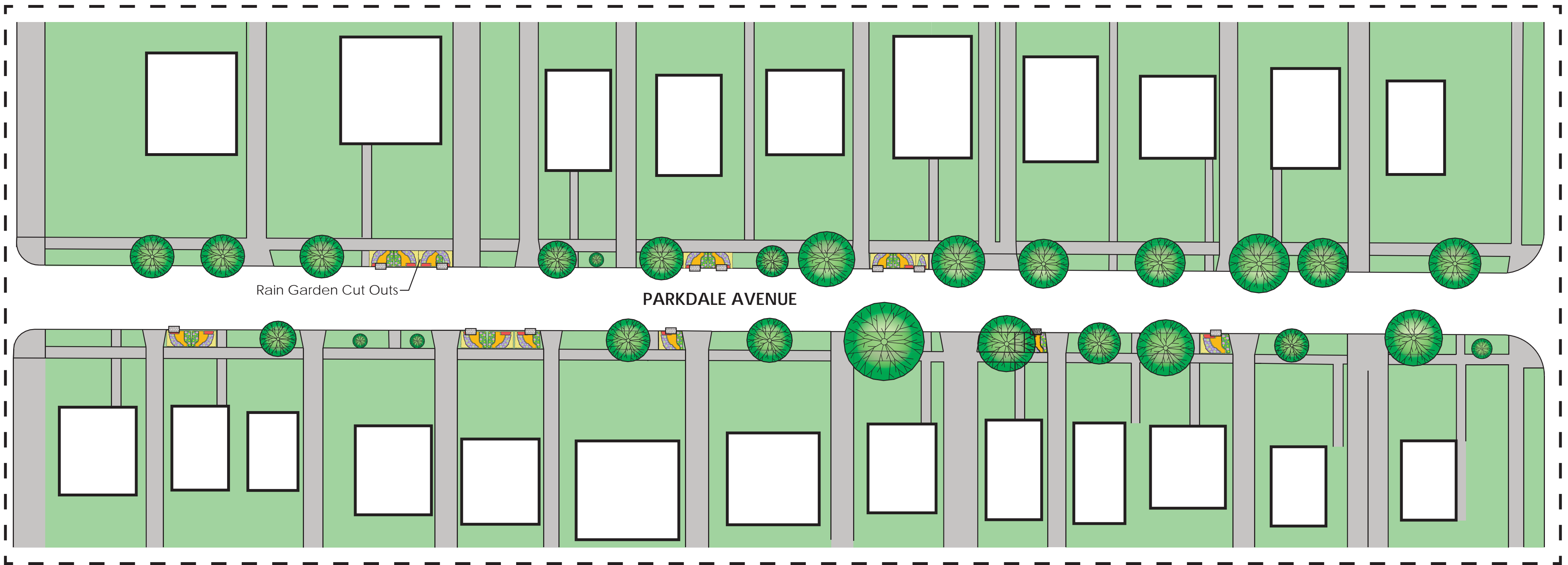

Plan NTS

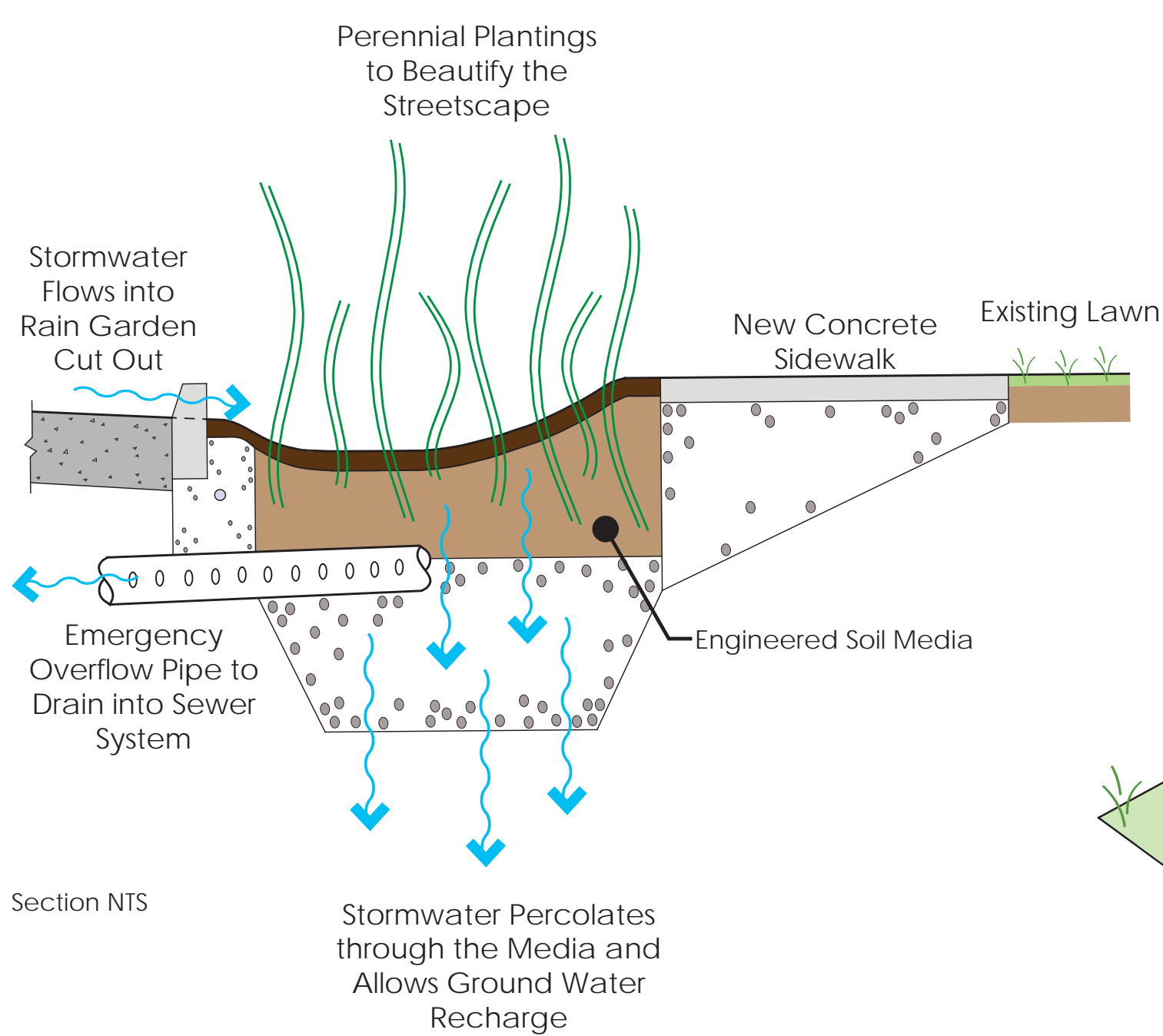

Section NTS

Green Infrastructure Rain Garden Cut Out Axonometric

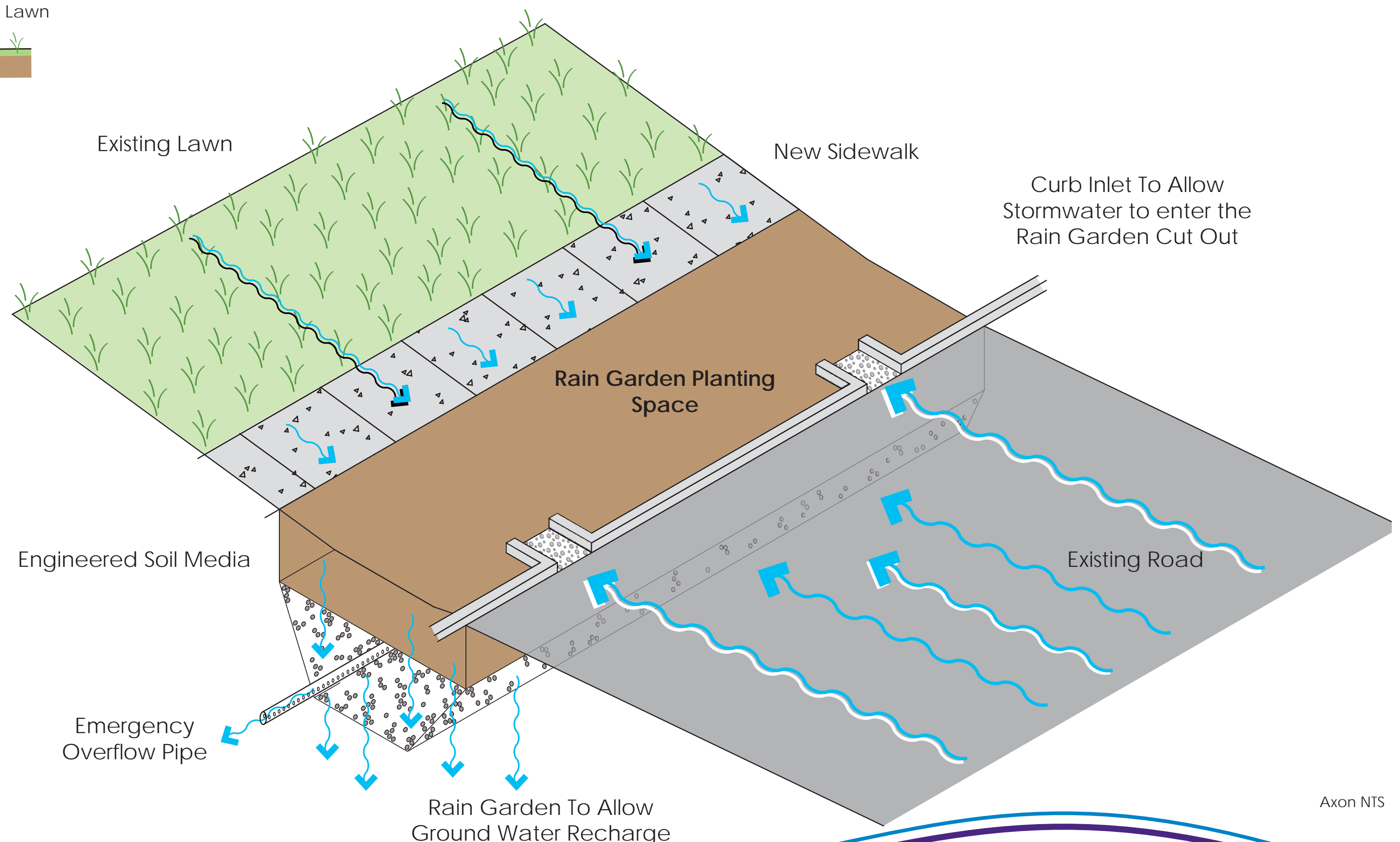

Axon NTS

Green Infrastructure Rain Garden Cut Out Section