

5 PLANTING THE TREE

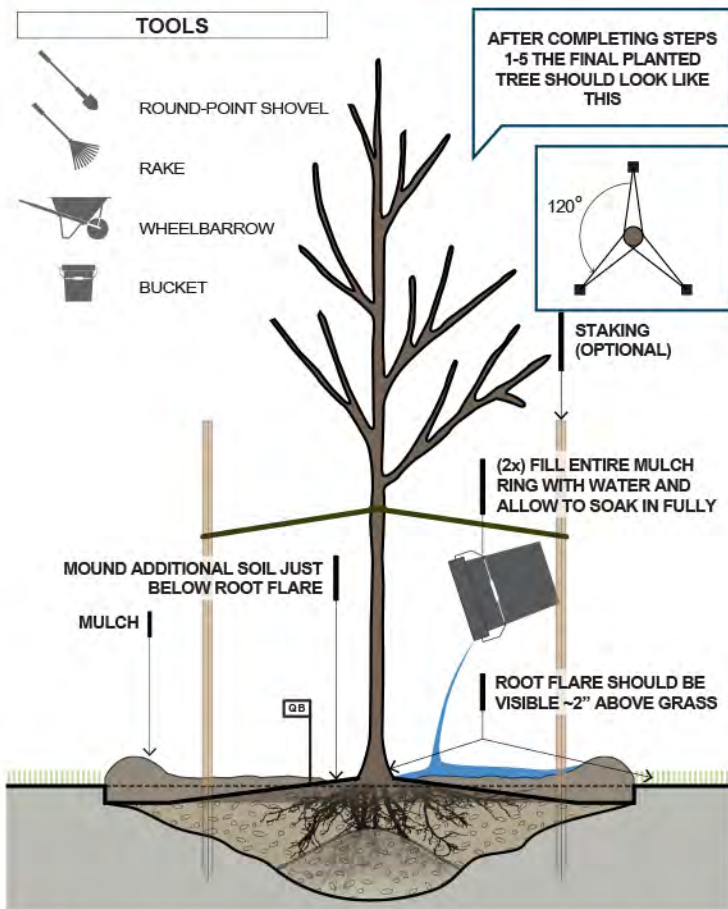

- 1 Set tree in center of the hole atop soil cone and spread bare roots out evenly. Place shovel across the hole to ensure root flare rests approximately 2" above the lawn. If more soil is needed to adjust height, make sure to pack it down **FIRMLY** under roots to prevent settling.
- 2 Ensure tree stands straight and stable when backfilling. **LIGHTLY** tamp down soil to remove air pockets. If surface roots are exposed, cover with extra soil as shown in the illustration.
- 3 Mulch entire planting area 3" deep, leaving a 3" gap between mulch and the trunk to keep root flare exposed (approximately 2 full wheelbarrows). Berm mulch at edges to help hold water.
- 4 Water thoroughly until entire planting area is saturated (approximately 3-4 buckets of water). After watering, gently tamp soil again with hand or foot to prevent air pockets.
- 5 Check with staff member to see if tree requires staking. Staff will instruct group in using approved materials and procedure for staking installation.
- 6 After a staff member approves finished planting site, place the small marking flag back in the ground near the tree trunk.
- 7 Rake up any dirt or mulch outside your planting area.



This project is made possible through a grant from the USDA Forest Service.

This Institution is an equal opportunity provider.



Additional support for this project provided by Erie County and the Erie County Parks Department



**BUFFALO NIAGARA
WATERKEEPER®**

TREE PLANTING FIELD GUIDE

BARE ROOT TREES



bnwaterkeeper.org/programs/restorecorps/

1 SUPPLIES & EXISTING CONDITIONS

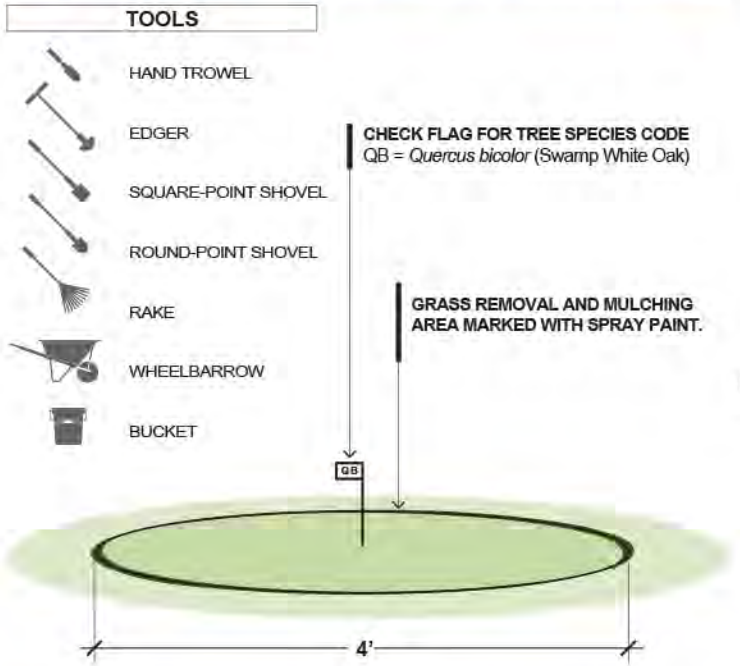

- 1 Check to make sure the planting area has necessary tools and has been properly marked out as shown above.
- 2 If a tree is not already at the planting area, refer to the species code on the flag and bring the proper tree to the planting area. Be sure to handle the tree carefully so as not to damage roots, trunk, or branches. Leave roots in bag until step 3, so they do not dry out.

2 PREPARING THE PLANTING AREA

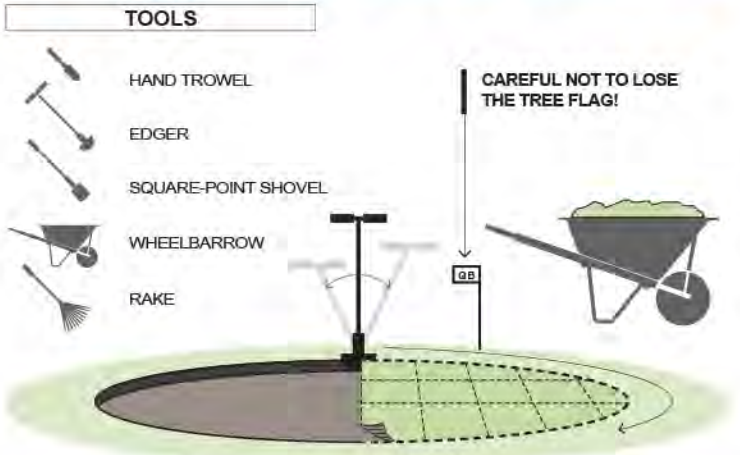

- 1 Cut into planting ring area using an edger. Move edger back-and-forth underneath sod to help loosen sections. A square-point shovel can then be used to lift up and remove the sections of lawn.
 - * Slice a grid pattern across the planting area with the edger to make sod removal easier (like cutting a party pizza!).
- 2 Knock-off good soil from the underside of sod sections into soil bucket using a hand trowel. Be careful not to drop removed lawn sections or root clumps back into planting area.
- 3 Rake up any stray sod material and use wheelbarrow to deliver removed lawn to stockpile area. This material will be picked-up and composted for future park plantings.

3 DIGGING THE HOLE

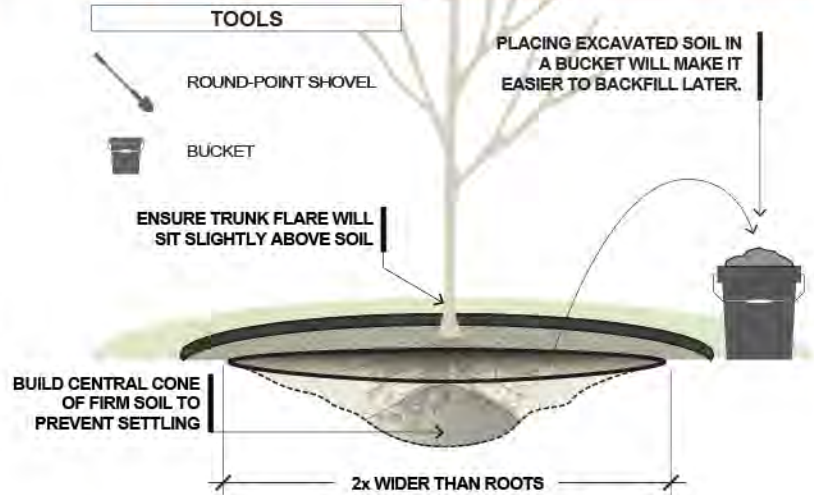

- 1 Using a round-point shovel, dig a shallow saucer-shaped hole twice-as-wide and slightly deeper than the root system; enough to accommodate roots without crowding or bending. Build a small cone-shaped dirt mound in the hole for roots to rest on.
- 2 To check planting depth, carefully remove roots from plastic bag and temporarily place tree into the hole with roots spread over the soil cone. The "trunk flare" (where the trunk and root system meet) should be slightly above the lawn.
- 3 **IMPORTANT STEP:** To prevent settling, make sure bottom of the tree will sit on compacted soil. If hole is too deep, return soil and pack down firmly before planting. After any final adjustments have been made, carefully set tree aside until step 4.

4 PREPARING THE TREE

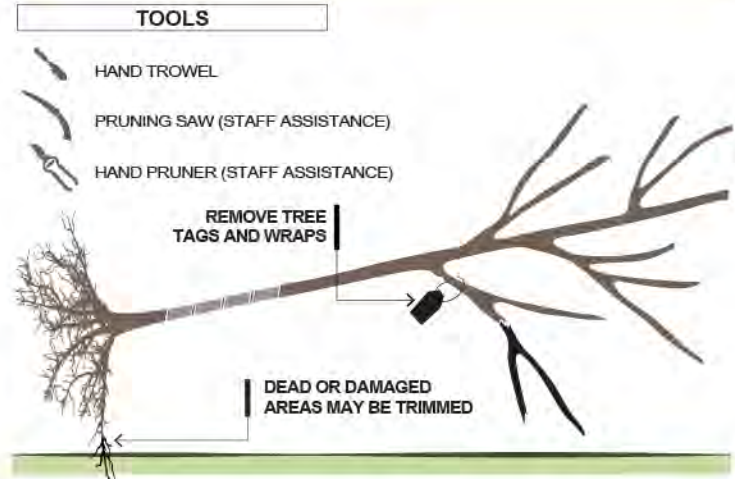

- 1 Carefully lean tree on its side as to not break any branches. With assistance from a staff member, inspect condition of the branch and root systems, trimming any areas that appear dead or damaged. Do not trim roots just to make them fit the hole.
- 2 Remove all plastic tags and wraps from the tree and dispose of in designated trash receptacle.
- 3 **IMPORTANT NOTE:** After tree roots have been removed from their moisture bag, ensure exposed tree is planted and watered in a timely manner. It is important to prevent drying and damage to the bare-root system.

PLANTING THE TREE